

# ACCOMMODATION LAYOUT

(Required by Centre Staff 2 weeks prior to visit)

Group \_\_\_\_\_ Staff \_\_\_\_\_ Boys \_\_\_\_\_ Girls \_\_\_\_\_

Group \_\_\_\_\_ Staff \_\_\_\_\_ Boys \_\_\_\_\_ Girls \_\_\_\_\_

Visit Date: \_\_\_\_\_

## DURLSTON

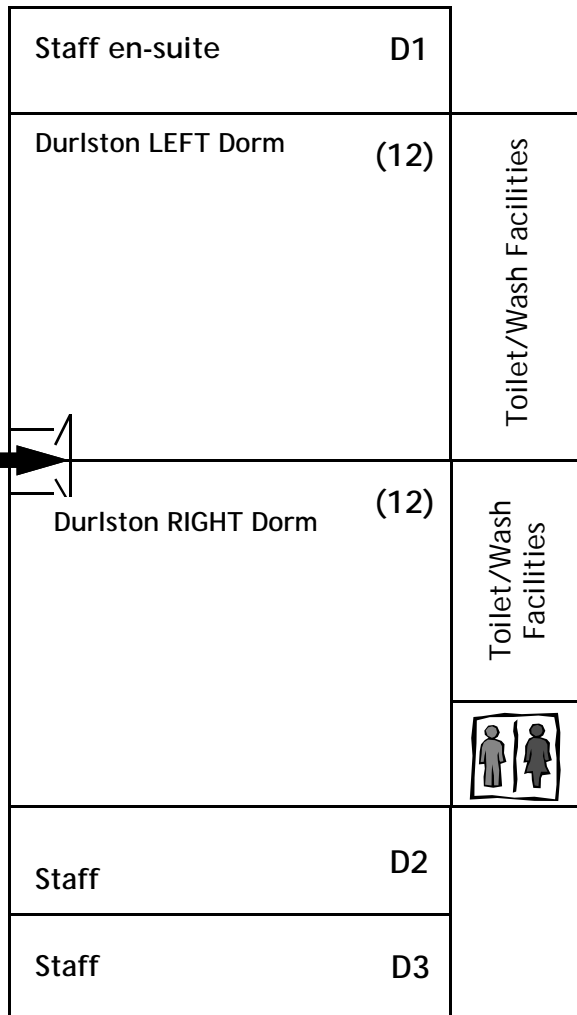

## BALLARD

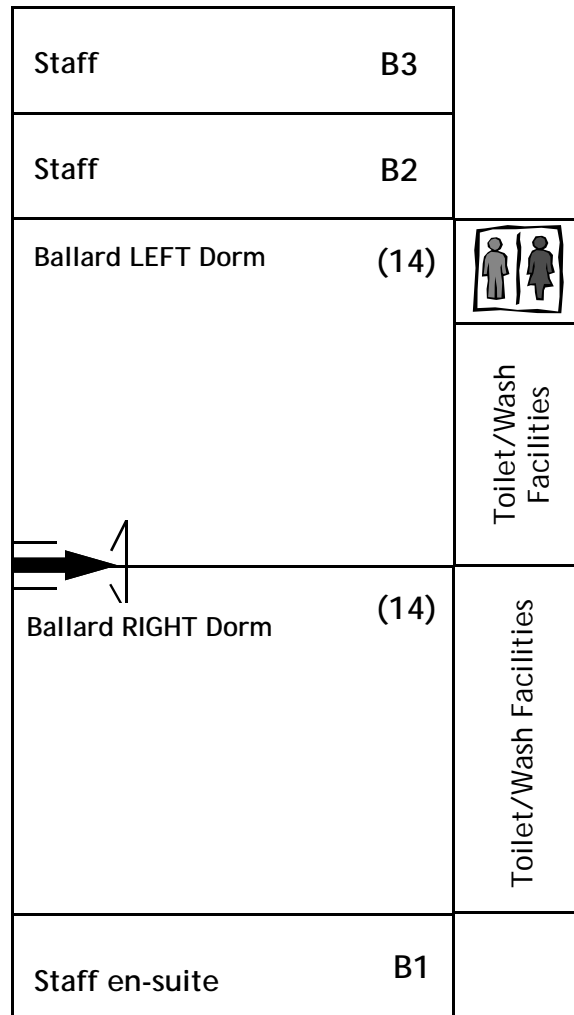

## PEVERIL (all en suite)

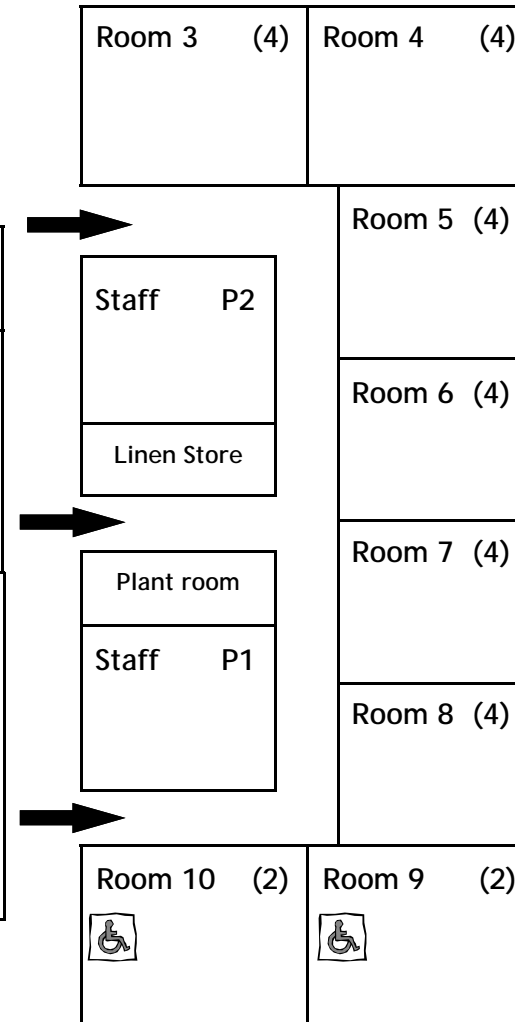

## FLAT (en suite)

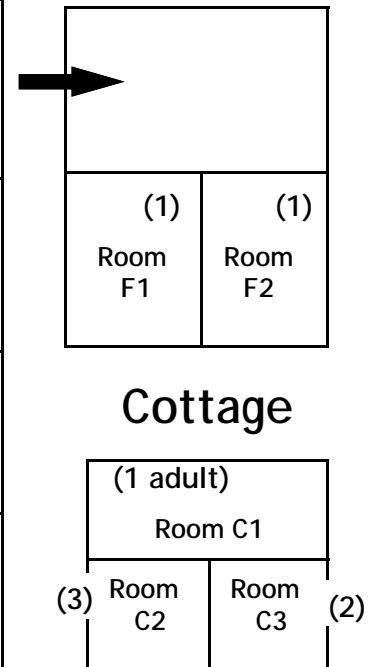

**KEY**

(4) Number of beds

➔ Entrance

Wheelchair facilities & intercom

Staff toilet/wash facilities